

Blue highlighted sections contain holes announced in latest release. Please see sections for assay intervals.

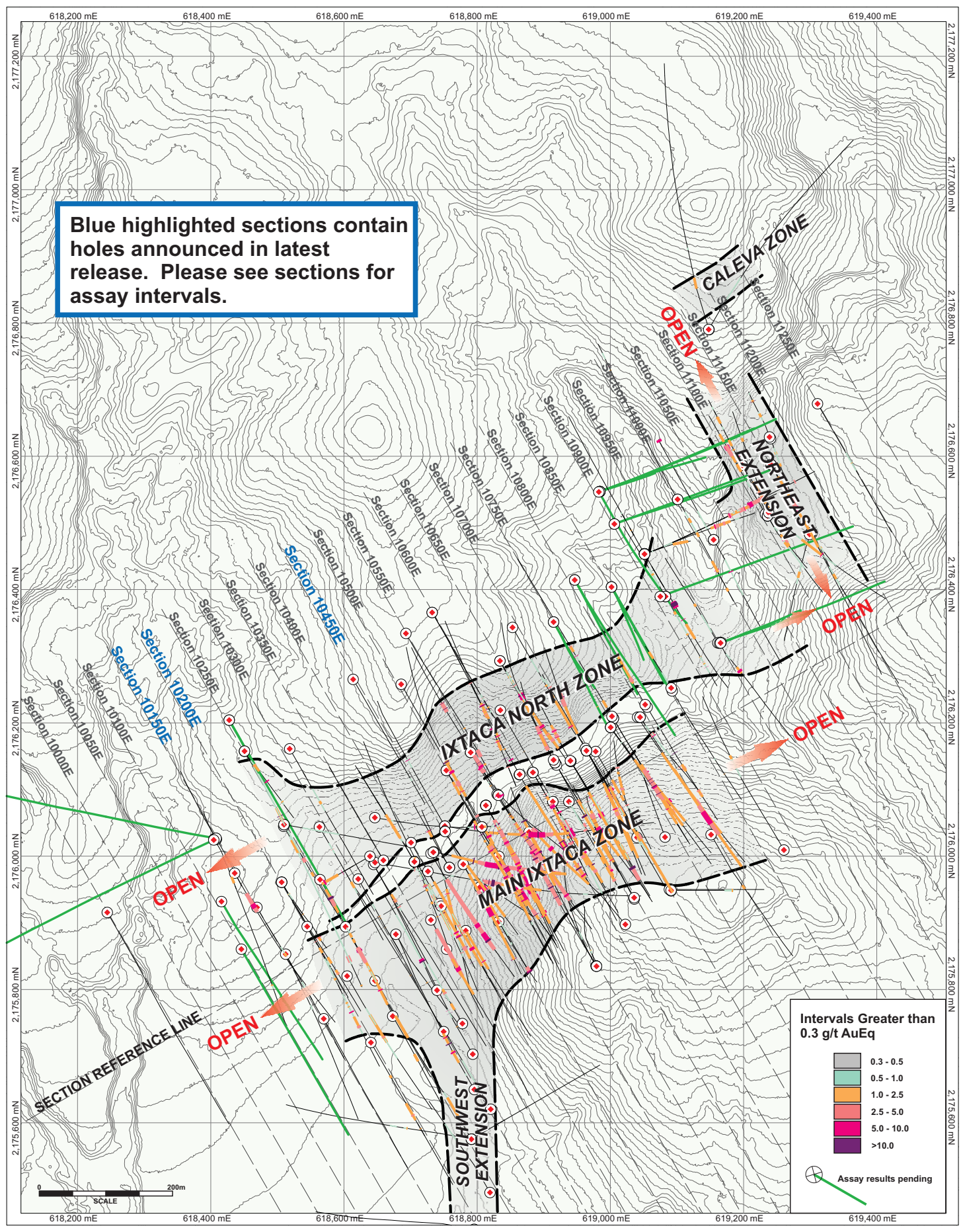

Intervals Greater than 0.3 g/t AuEq

- 0.3 - 0.5
- 0.5 - 1.0
- 1.0 - 2.5
- 2.5 - 5.0
- 5.0 - 10.0
- >10.0

Assay results pending

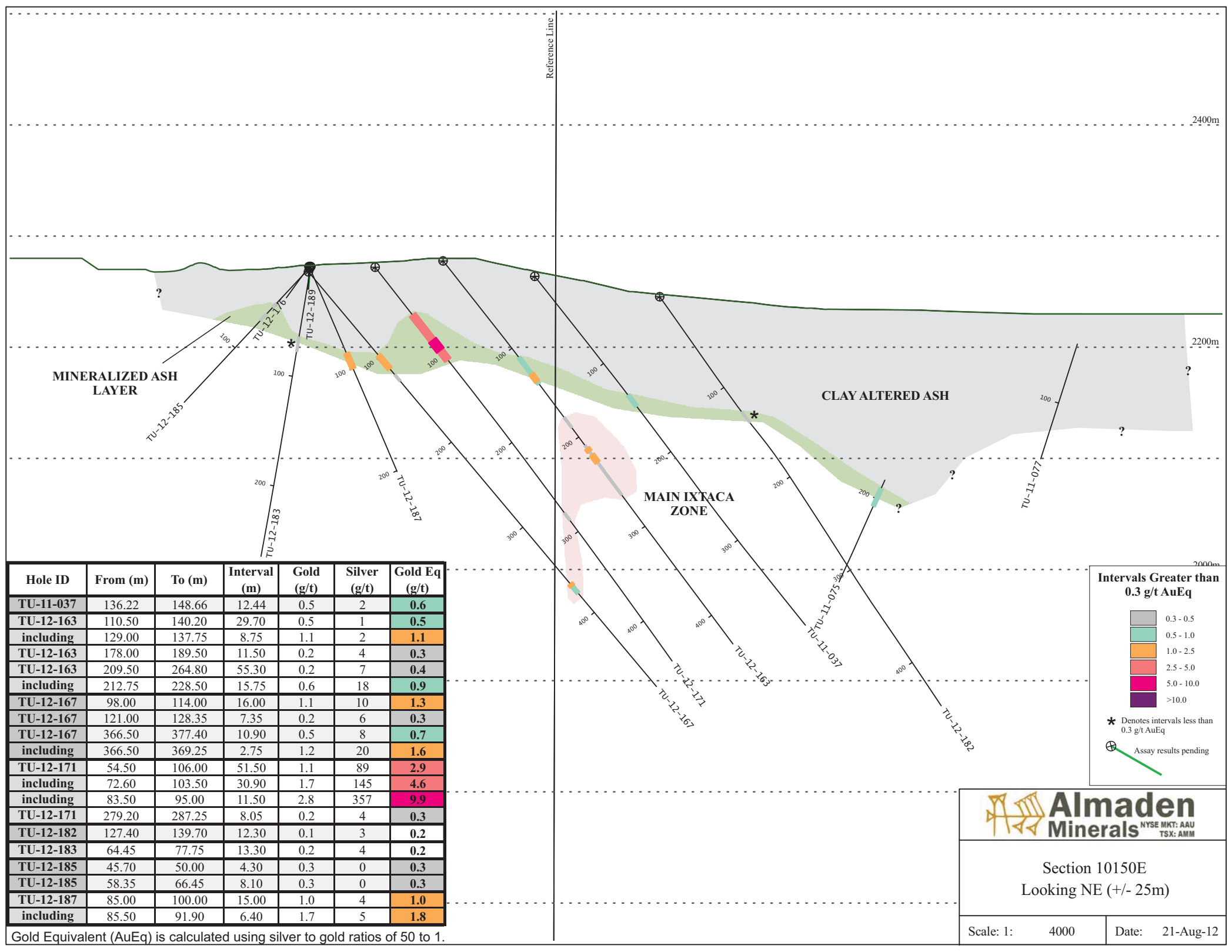

Hole ID	From (m)	To (m)	Interval (m)	Gold (g/t)	Silver (g/t)	Gold Eq (g/t)
TU-11-037	136.22	148.66	12.44	0.5	2	0.6
TU-12-163	110.50	140.20	29.70	0.5	1	0.5
including	129.00	137.75	8.75	1.1	2	1.1
TU-12-163	178.00	189.50	11.50	0.2	4	0.3
TU-12-163	209.50	264.80	55.30	0.2	7	0.4
including	212.75	228.50	15.75	0.6	18	0.9
TU-12-167	98.00	114.00	16.00	1.1	10	1.3
TU-12-167	121.00	128.35	7.35	0.2	6	0.3
TU-12-167	366.50	377.40	10.90	0.5	8	0.7
including	366.50	369.25	2.75	1.2	20	1.6
TU-12-171	54.50	106.00	51.50	1.1	89	2.9
including	72.60	103.50	30.90	1.7	145	4.6
including	83.50	95.00	11.50	2.8	357	9.9
TU-12-171	279.20	287.25	8.05	0.2	4	0.3
TU-12-182	127.40	139.70	12.30	0.1	3	0.2
TU-12-183	64.45	77.75	13.30	0.2	4	0.2
TU-12-185	45.70	50.00	4.30	0.3	0	0.3
TU-12-185	58.35	66.45	8.10	0.3	0	0.3
TU-12-187	85.00	100.00	15.00	1.0	4	1.0
including	85.50	91.90	6.40	1.7	5	1.8

Gold Equivalent (AuEq) is calculated using silver to gold ratios of 50 to 1.

**Intervals Greater than 0.3 g/t AuEq**

- 0.3 - 0.5
- 0.5 - 1.0
- 1.0 - 2.5
- 2.5 - 5.0
- 5.0 - 10.0
- >10.0

\* Denotes intervals less than 0.3 g/t AuEq

⊕ Assay results pending



**Almaden Minerals**  
NYSE MKT: AAU  
TSX: AMM

Section 10150E  
Looking NE (+/- 25m)

Scale: 1: 4000      Date: 21-Aug-12

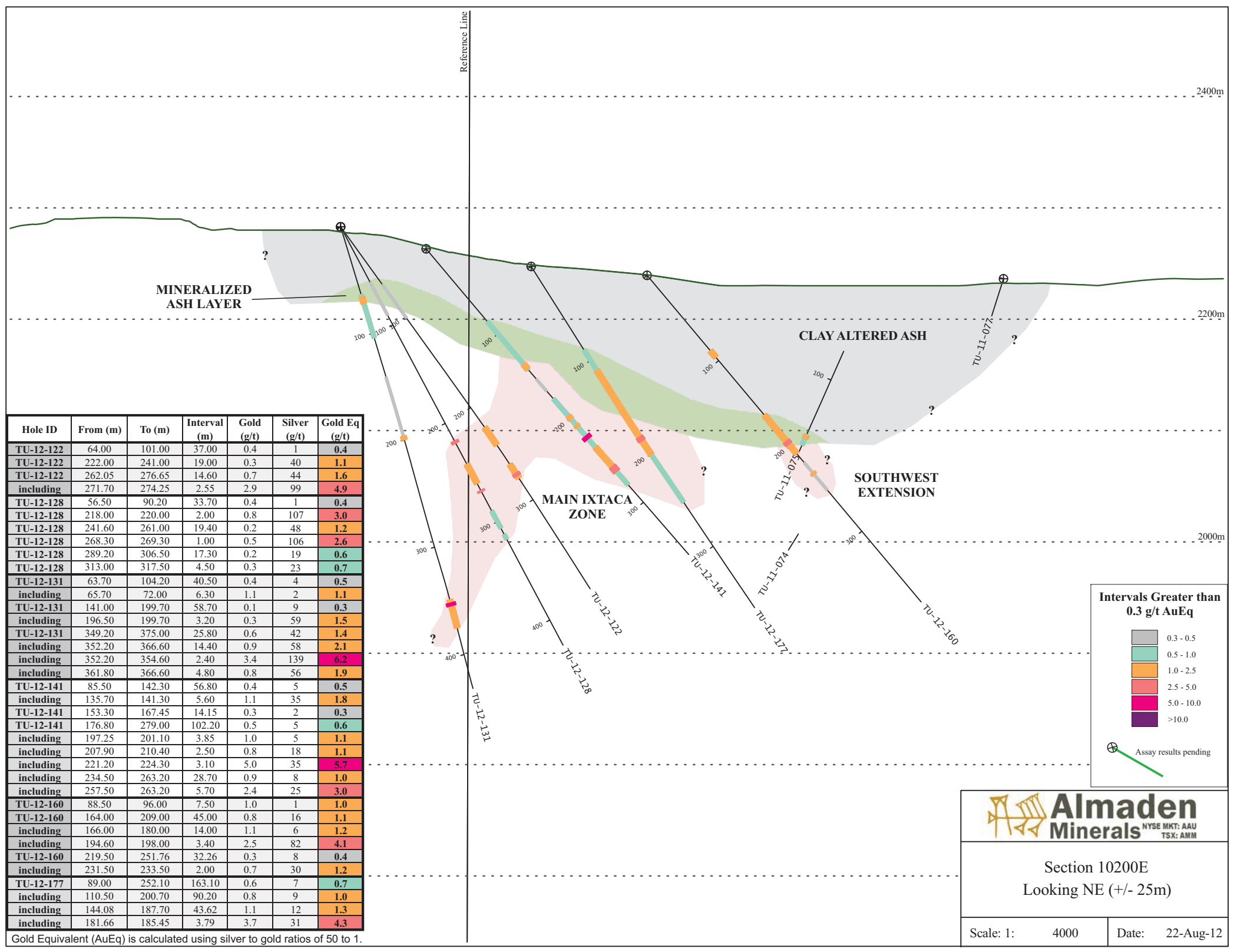

Hole ID	From (m)	To (m)	Interval (m)	Gold (g/t)	Silver (g/t)	Gold Eq (g/t)
TU-12-122	64.00	101.00	37.00	0.4	1	0.4
TU-12-122	222.00	241.00	19.00	0.3	40	1.1
TU-12-122	262.05	276.65	14.60	0.7	44	1.6
including	271.70	274.25	2.55	2.9	99	4.9
TU-12-128	56.50	90.20	33.70	0.4	1	0.4
TU-12-128	218.00	220.00	2.00	0.8	107	3.0
TU-12-128	241.60	261.00	19.40	0.2	48	1.2
TU-12-128	268.30	269.30	1.00	0.5	106	2.6
TU-12-128	289.20	306.50	17.30	0.2	19	0.6
TU-12-128	313.00	317.50	4.50	0.3	23	0.7
TU-12-131	63.70	104.20	40.50	0.4	4	0.5
including	65.70	72.00	6.30	1.1	2	1.1
TU-12-131	141.00	199.70	58.70	0.1	9	0.3
including	196.50	199.70	3.20	0.3	59	1.5
TU-12-131	349.20	375.00	25.80	0.6	42	1.4
including	352.20	366.60	14.40	0.9	58	2.1
including	352.20	354.60	2.40	3.4	139	6.2
including	361.80	366.60	4.80	0.8	56	1.9
TU-12-141	85.50	142.30	56.80	0.4	5	0.5
including	135.70	141.30	5.60	1.1	35	1.8
TU-12-141	153.30	167.45	14.15	0.3	2	0.3
TU-12-141	176.80	279.00	102.20	0.5	5	0.6
including	197.25	201.10	3.85	1.0	5	1.1
including	207.90	210.40	2.50	0.8	18	1.1
including	221.20	224.30	3.10	5.0	35	5.7
including	234.50	263.20	28.70	0.9	8	1.0
including	257.50	263.20	5.70	2.4	25	3.0
TU-12-160	88.50	96.00	7.50	1.0	1	1.0
TU-12-160	164.00	209.00	45.00	0.8	16	1.1
including	166.00	180.00	14.00	1.1	6	1.2
including	194.60	198.00	3.40	2.5	82	4.1
TU-12-160	219.50	251.76	32.26	0.3	8	0.4
including	231.50	233.50	2.00	0.7	30	1.2
TU-12-177	89.00	252.10	163.10	0.6	7	0.7
including	110.50	200.70	90.20	0.8	9	1.0
including	144.08	187.70	43.62	1.1	12	1.3
including	181.66	185.45	3.79	3.7	31	4.3

Gold Equivalent (AuEq) is calculated using silver to gold ratios of 50 to 1.



Almaden Minerals  
NYSE MKT: AAU  
TSX: AMM

Section 10200E  
Looking NE (+/- 25m)

Scale: 1:	4000	Date: 22-Aug-12
-----------	------	-----------------

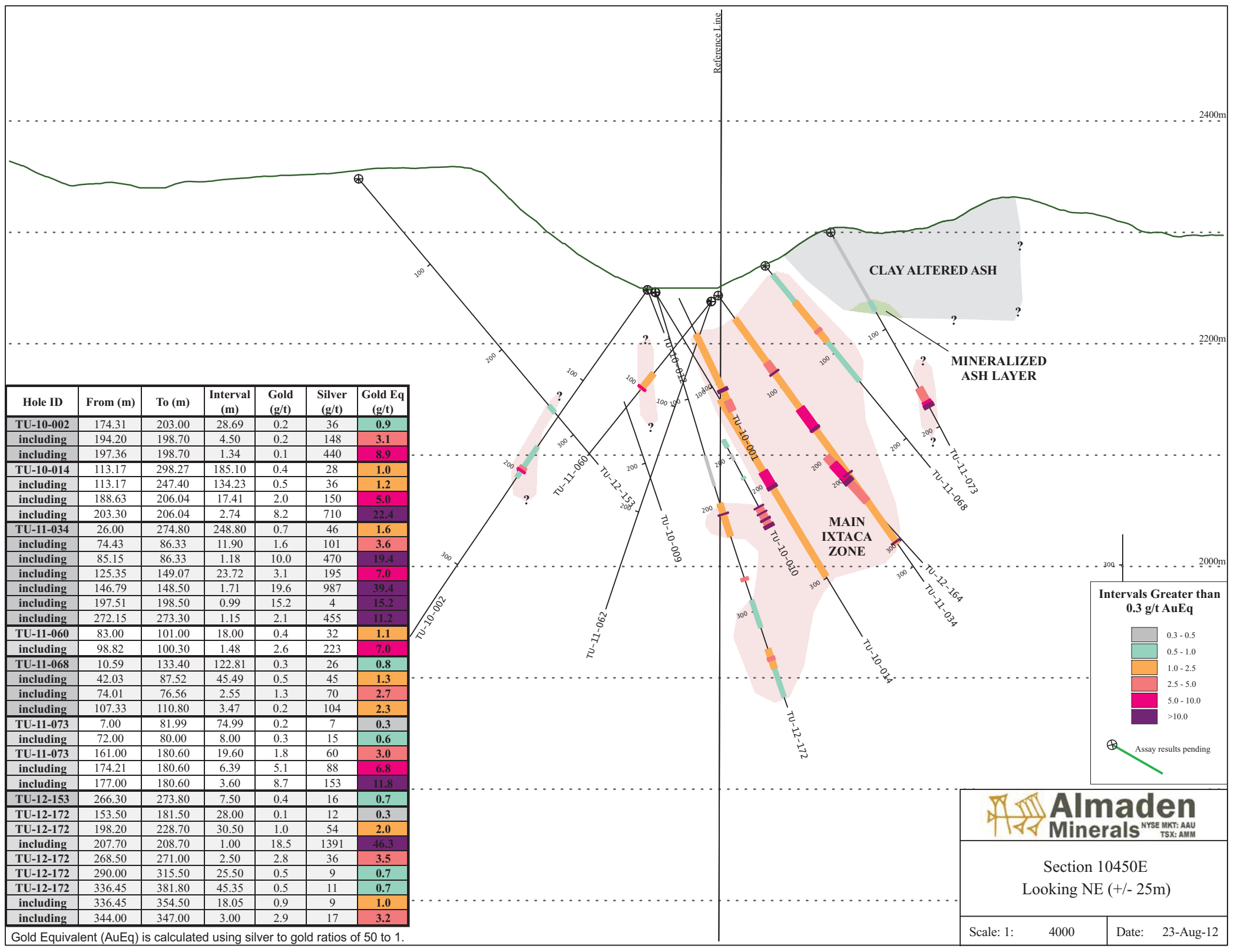

Hole ID	From (m)	To (m)	Interval (m)	Gold (g/t)	Silver (g/t)	Gold Eq (g/t)
TU-10-002	174.31	203.00	28.69	0.2	36	0.9
including	194.20	198.70	4.50	0.2	148	3.1
including	197.36	198.70	1.34	0.1	440	8.9
TU-10-014	113.17	298.27	185.10	0.4	28	1.0
including	113.17	247.40	134.23	0.5	36	1.2
including	188.63	206.04	17.41	2.0	150	5.0
including	203.30	206.04	2.74	8.2	710	22.4
TU-11-034	26.00	274.80	248.80	0.7	46	1.6
including	74.43	86.33	11.90	1.6	101	3.6
including	85.15	86.33	1.18	10.0	470	19.4
including	125.35	149.07	23.72	3.1	195	7.0
including	146.79	148.50	1.71	19.6	987	39.4
including	197.51	198.50	0.99	15.2	4	15.2
including	272.15	273.30	1.15	2.1	455	11.2
TU-11-060	83.00	101.00	18.00	0.4	32	1.1
including	98.82	100.30	1.48	2.6	223	7.0
TU-11-068	10.59	133.40	122.81	0.3	26	0.8
including	42.03	87.52	45.49	0.5	45	1.3
including	74.01	76.56	2.55	1.3	70	2.7
including	107.33	110.80	3.47	0.2	104	2.3
TU-11-073	7.00	81.99	74.99	0.2	7	0.3
including	72.00	80.00	8.00	0.3	15	0.6
TU-11-073	161.00	180.60	19.60	1.8	60	3.0
including	174.21	180.60	6.39	5.1	88	6.8
including	177.00	180.60	3.60	8.7	153	11.8
TU-12-153	266.30	273.80	7.50	0.4	16	0.7
TU-12-172	153.50	181.50	28.00	0.1	12	0.3
TU-12-172	198.20	228.70	30.50	1.0	54	2.0
including	207.70	208.70	1.00	18.5	1391	46.3
TU-12-172	268.50	271.00	2.50	2.8	36	3.5
TU-12-172	290.00	315.50	25.50	0.5	9	0.7
TU-12-172	336.45	381.80	45.35	0.5	11	0.7
including	336.45	354.50	18.05	0.9	9	1.0
including	344.00	347.00	3.00	2.9	17	3.2

Gold Equivalent (AuEq) is calculated using silver to gold ratios of 50 to 1.

**Intervals Greater than 0.3 g/t AuEq**

- 0.3 - 0.5
- 0.5 - 1.0
- 1.0 - 2.5
- 2.5 - 5.0
- 5.0 - 10.0
- >10.0

Assay results pending

**Almaden Minerals**  
 NYSE MKT: AAU  
 TSX: AMM

Section 10450E  
 Looking NE (+/- 25m)

Scale: 1: 4000      Date: 23-Aug-12