

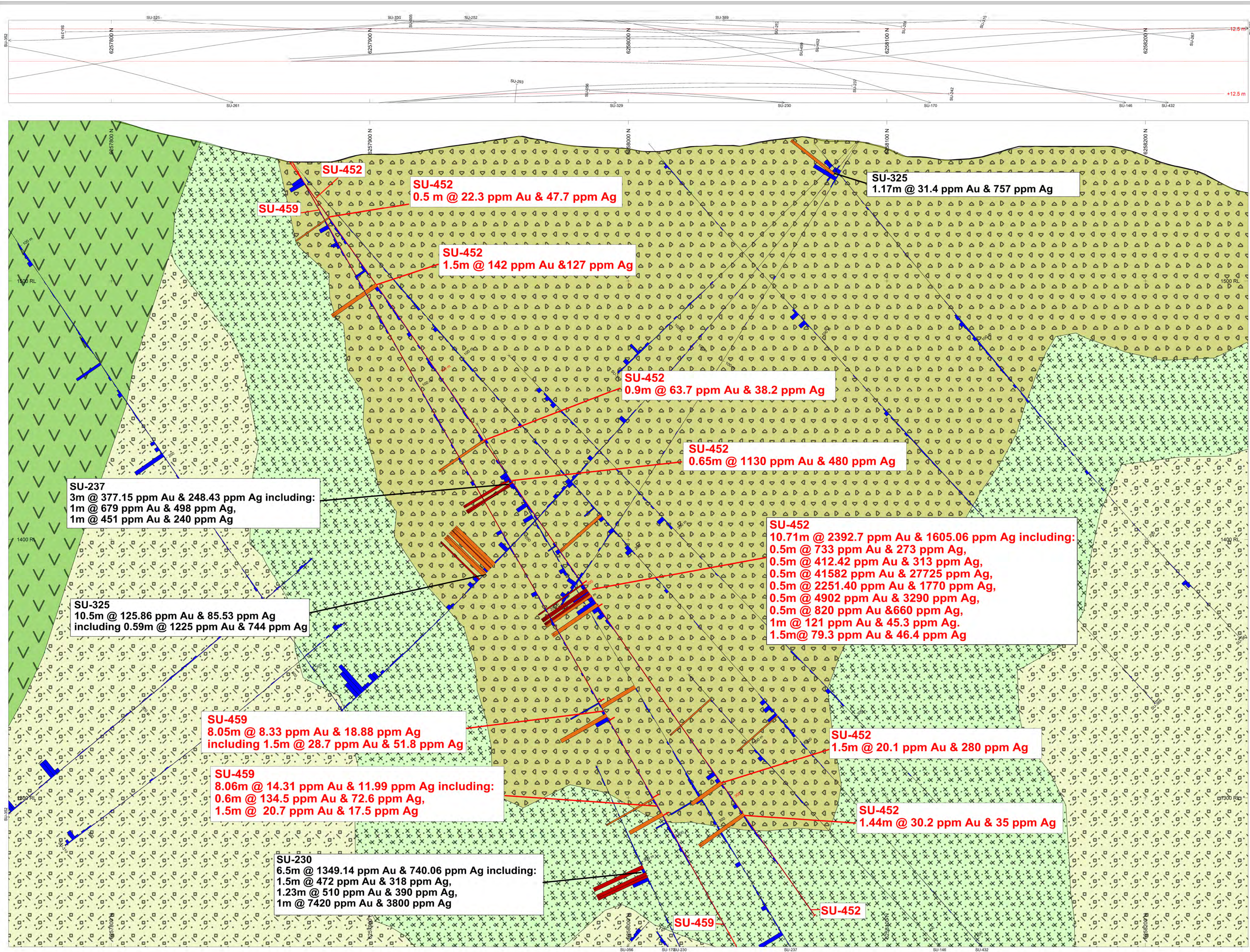

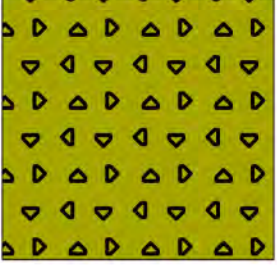

VOK Zone Cross Section 426625 mE

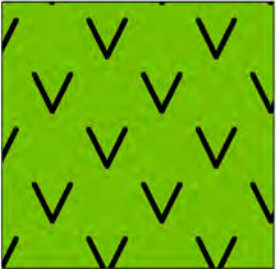
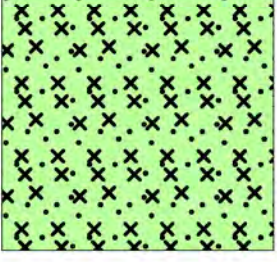

Lower Jurassic

-  Fragmental Volcanic Rocks
-hornblende and/or feldspar phyric fragmental rocks; fine lapilli and lithic crystal ash tuff; local coarse lapilli tuff and tuff-breccia, rare fine grained volcaniclastic rocks
-  Lafite flows
-massive hornblende and/or feldspar phyric lafite flows and subordinate fragmental rocks
-  Polyolithic conglomerate
-polyolithic volcanic pebble, cobble, granule and local boulder conglomerate and associated sandstone and rare mudstone
-  Silicified rocks
-conglomerate, sandstone, local tuff and mudstone
-  Lower volcaniclastic sequence
-siltstone, sandstone, and conglomerate; green to dark grey to black

Colour	Au (ppm)
	> 300
	20 - 300
	0 - 20

1 mm = 1 ppm Au up to 30 ppm Au

Drill hole traces are projected onto section from up to 12.5m to the east or west of the section line

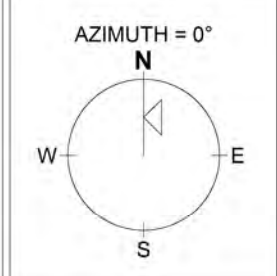
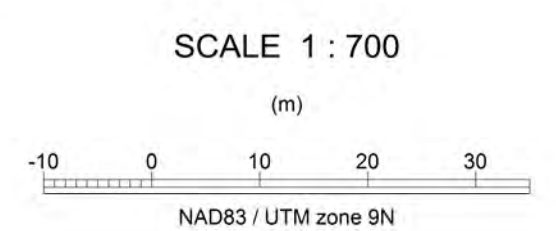

SU-237
3m @ 377.15 ppm Au & 248.43 ppm Ag including:
1m @ 679 ppm Au & 498 ppm Ag,
1m @ 451 ppm Au & 240 ppm Ag

SU-325
10.5m @ 125.86 ppm Au & 85.53 ppm Ag
including 0.59m @ 1225 ppm Au & 744 ppm Ag

SU-459
8.05m @ 8.33 ppm Au & 18.88 ppm Ag
including 1.5m @ 28.7 ppm Au & 51.8 ppm Ag

SU-459
8.06m @ 14.31 ppm Au & 11.99 ppm Ag including:
0.6m @ 134.5 ppm Au & 72.6 ppm Ag,
1.5m @ 20.7 ppm Au & 17.5 ppm Ag

SU-230
6.5m @ 1349.14 ppm Au & 740.06 ppm Ag including:
1.5m @ 472 ppm Au & 318 ppm Ag,
1.23m @ 510 ppm Au & 390 ppm Ag,
1m @ 7420 ppm Au & 3800 ppm Ag

SU-452
0.5 m @ 22.3 ppm Au & 47.7 ppm Ag

SU-452
1.5m @ 142 ppm Au & 127 ppm Ag

SU-452
0.9m @ 63.7 ppm Au & 38.2 ppm Ag

SU-452
0.65m @ 1130 ppm Au & 480 ppm Ag

SU-452
10.71m @ 2392.7 ppm Au & 1605.06 ppm Ag including:
0.5m @ 733 ppm Au & 273 ppm Ag,
0.5m @ 412.42 ppm Au & 313 ppm Ag,
0.5m @ 41582 ppm Au & 27725 ppm Ag,
0.5m @ 2251.40 ppm Au & 1770 ppm Ag,
0.5m @ 4902 ppm Au & 3290 ppm Ag,
0.5m @ 820 ppm Au & 660 ppm Ag,
1m @ 121 ppm Au & 45.3 ppm Ag,
1.5m @ 79.3 ppm Au & 46.4 ppm Ag

SU-452
1.5m @ 20.1 ppm Au & 280 ppm Ag

SU-452
1.44m @ 30.2 ppm Au & 35 ppm Ag

SU-325
1.17m @ 31.4 ppm Au & 757 ppm Ag