

APPENDIX TWO

SOIL GEOCHEMISTRY AND TENEMENT (CLAIM) PLAN

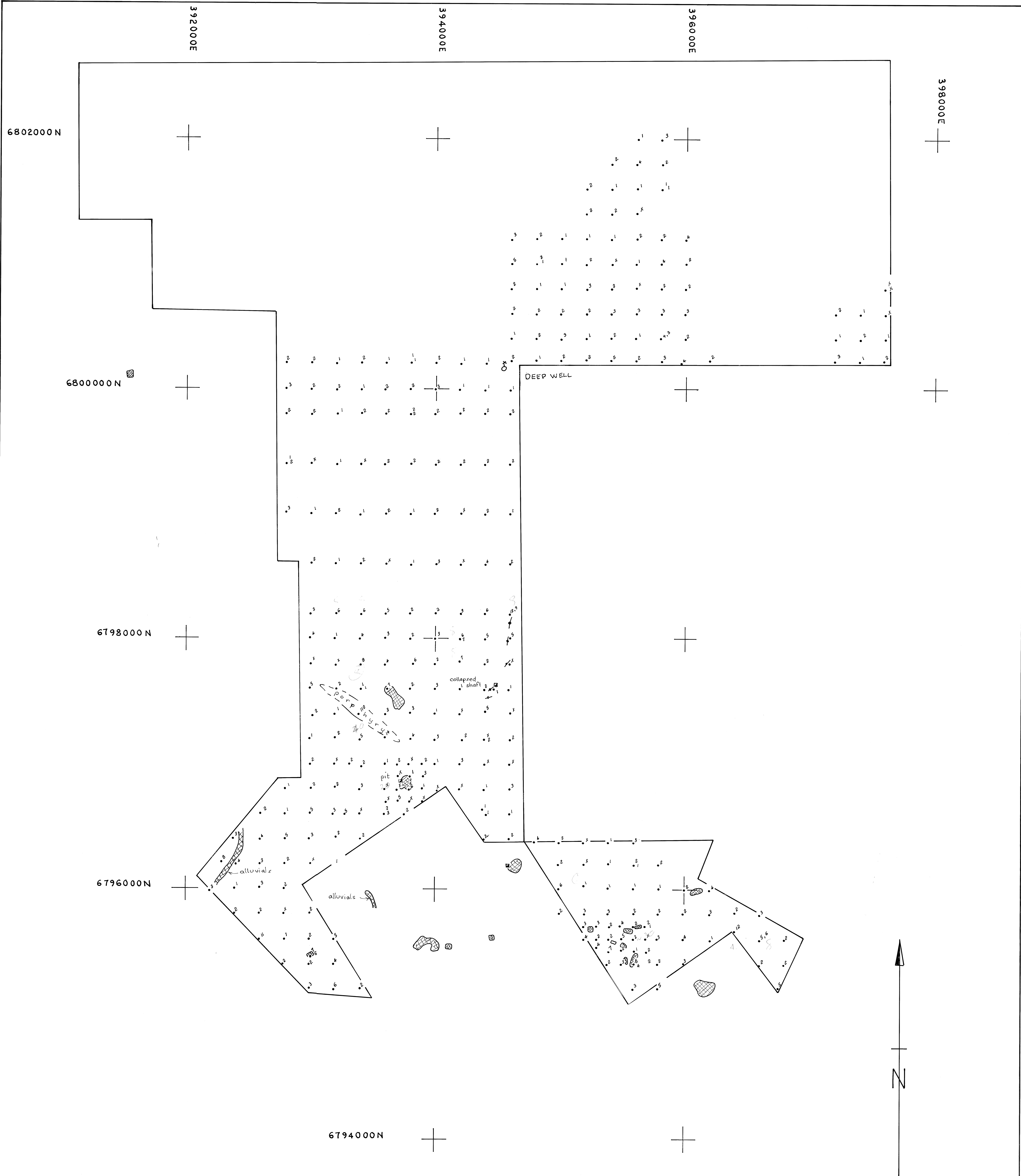

• 1/4 PPB gold
Metal detector scrapings and alluvial gold workings

- NOTES:
1. Minus 80 mesh soil samples were collected from between 5 and 20cm depth, generally on a 200m by 200m grid, closing down to 100m by 100m in vicinity of metal detector scrapings.
 2. Two values at a sample site represent duplicates
 3. Areas in the northern part of the tenements believed to overlie Tertiary palaeochannels or granite were not sampled. A study of satellite imagery and aeromagnetics may lead to reinterpretation, requiring additional soil sampling.
 4. 400m line spacing between 6798000N and 6800000N are infills between 400m by 50m soil sampling carried out by Goldfields Exploration in 2000 (WAMEX report A63435)

0 1km

SUPERIOR MINING INTERNATIONAL CORPORATION
REDCASTLE PROJECT
GOLD GEOCHEMISTRY
SCALE 1:10 000 DATUM GDA94
TERRY TAYLOR DEC 2013
DRAWING No RP006